



# Cella<sup>®</sup> flex & Cella<sup>®</sup> starr

The robust & flexible jackets



## Greiner PURTEC

Greiner PURTEC sets and raises the standards of insulation for warm water tanks. We focus on the requirements of the customers. We still set great store by emphasizing Research and Development activities, testing and patenting new products with better insulation properties. In an era of high energy costs and worldwide issues such as global warming, insulation is becoming more and more important. In order to contribute, we always focus on our customer's needs and new innovative technologies.

## Contact

office: Greiner PURtec GmbH  
Emesbergstrasse 33, 4643 Pettenbach, Austria  
[office.at@greiner-purtec.com](mailto:office.at@greiner-purtec.com)

production: Greiner PURtec CZ spol. s r.o.  
Komenského 895, 340 22 Nýrsko, Czechia  
[office.cz@greiner-purtec.com](mailto:office.cz@greiner-purtec.com)

[greiner-purtec.com](http://greiner-purtec.com)





# Cella<sup>®</sup>flex

The Cellaflex jacket serves as outer layer for foam-in-place tanks (directly isolated tanks as well as Cella<sup>®</sup>Cool). Their purpose is to add a nice look to existing insulations. The jacket also increases firmness and visual appearance.

It consists of 2 layers. PVC top film and inner PU soft foam. Furthermore, tolerances can be absorbed due to the elasticity of the foam.

The hole cutting in the Cellaflex jacket can be done individually. The cut-outs for connection pipes can be covered by plastic rosettes. Fastening to a tank works with a classic ZIP.



## Why Cella<sup>®</sup>flex

- 1 Better look, top quality.  
You will get a new look with a stable visual appearance.
- 2 Simple upgrade.  
It is the simplest way to upgrade your current solution.
- 3 Easy to manipulate & install.  
Very light, classic zip fastening. It can't be easier.
- 4 Individual solutions.  
Every product is aligned to a specific tank.
- 5 We love our planet, so we set an example.  
Low weight, no harmful substances.

## Description

- 1 Outer layer of Cella®flex, made of PVC and laminated to the soft 5 mm PU foam.
- 2 Inner layer of Cellaflex coating, high quality PU foam.
- 3 Classic ZIP fastening.
- 4 Holes for connection pipes.
- 5 Foam-in-place tank
- 6 Rosettes and caps
- 7 Top lid

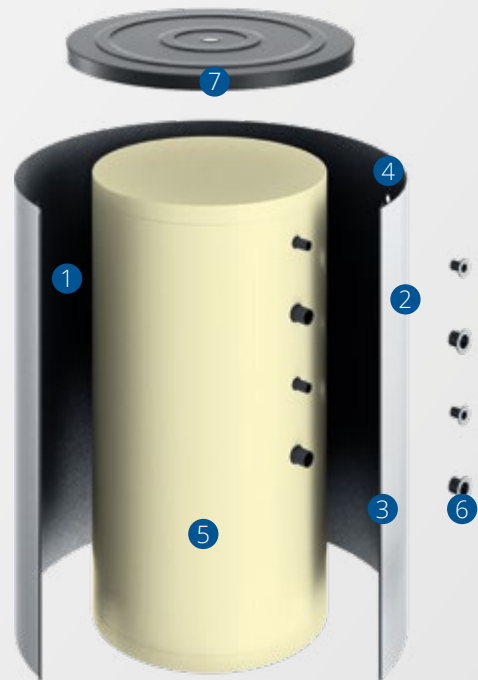

## Specifications

### The important facts

surface	PVC film
foam thickness	5 mm
fastening	classic ZIP
workers for installation	1
special aids or tools	no need
custom adjustments	yes

### Surface finishes

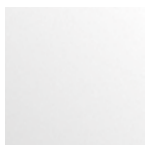

grainy PS



different colours

## 4 easy steps

With this 4 easy steps, 1 worker can install the jacket in just a few minutes:

- 1 Prepare all parts
- 2 Install & secure the jacket
- 3 Cover the top
- 4 Finish all the details & connections

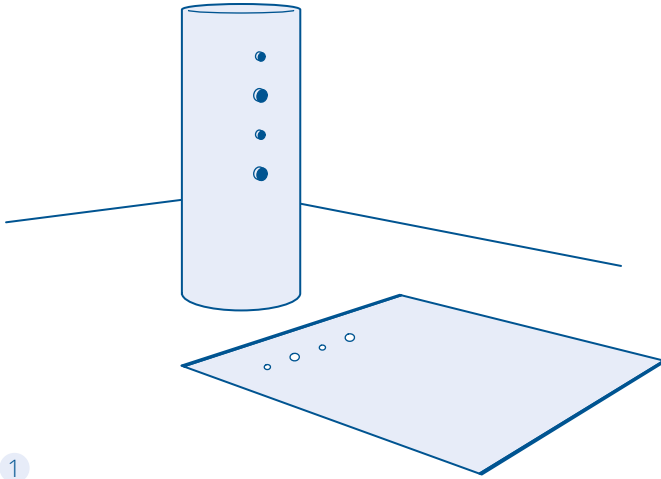

1

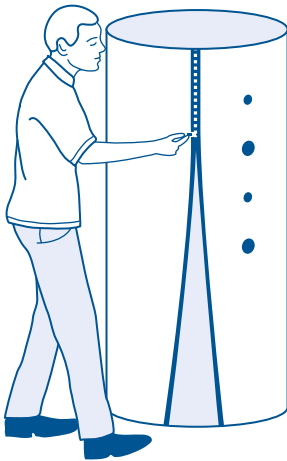

2

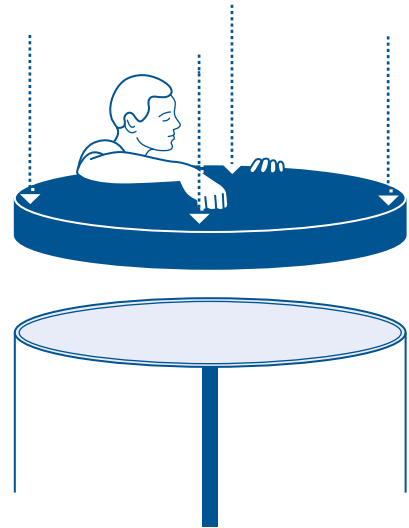

3

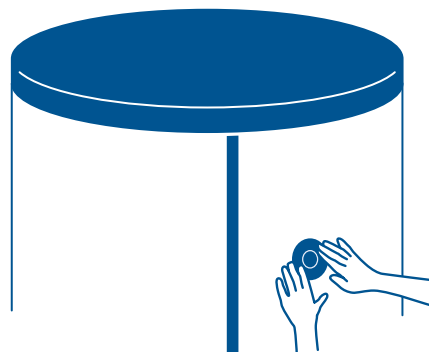

4

# Cella®starr

The main purpose of the Cella®starr jacket for foam-in-place tanks (directly insulated tanks) is to add an outer layer which provides additional significant resistance and a nice look to existing insulation. It is considered an alternative to conventional soft jackets.

The jacket is made from 1 layer of impact-resistant polystyrene. The holes in the Cellastarr jacket are made on individual demand. An extruded closing slat and covering slat is used as insulation closure and fastening to the tank. Deliveries may be made with rosettes and a thermoformed lid.



## Why Cella®starr

### 1 Better look, top quality

You will get new look with a stable visual appearance.

### 2 Simple upgrade.

It is the simplest way to upgrade you current solution.

### 3 Easy to manipulate & install.

Super light, locked with a slat. Nice & easy.

### 4 Individual solutions.

Every product is aligned to a specific tank.

### 5 We love our planet, so we set an example.

100% recyclability, no harmful substances.

## Description

- 1 The main body of Cellastarr coating is made of impact-resistant polystyrene.
- 2 Closing slat or hook and loop fastener
- 3 Covering slat (not for hook and loop).
- 4 Individual holes.
- 5 Foam-in-place tank.
- 6 Rosettes and caps
- 7 Top lid Insulation as insulating cover.

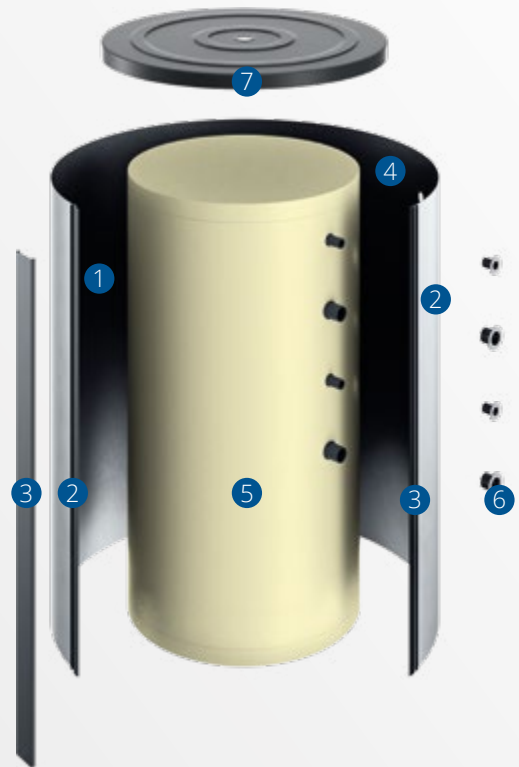

## Specifications

The important facts

surface	PS
thickness	1 mm
fastening	closing slat or hook and loop
workers for installation	1
special aids or tools	no need
custom adjustments	yes

Surface finishes



grainy PS

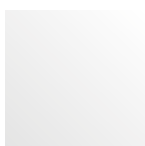

smooth PS



different colours



custom print

## 4 easy steps

With this 4 easy steps, 1 worker can install the jacket in just a few minutes:

- 1 Prepare all parts
- 2 Install & secure the jacket
- 3 Cover the top, finish the details
- 4 If necessary, install the covering slat (not for hook and loop)

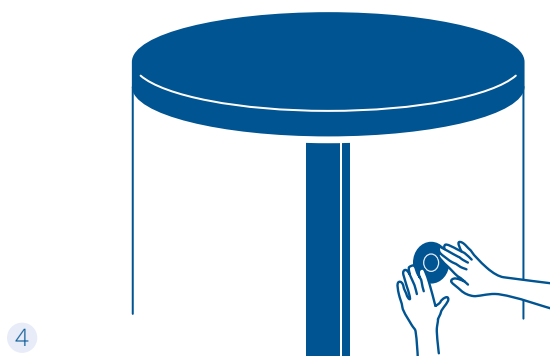
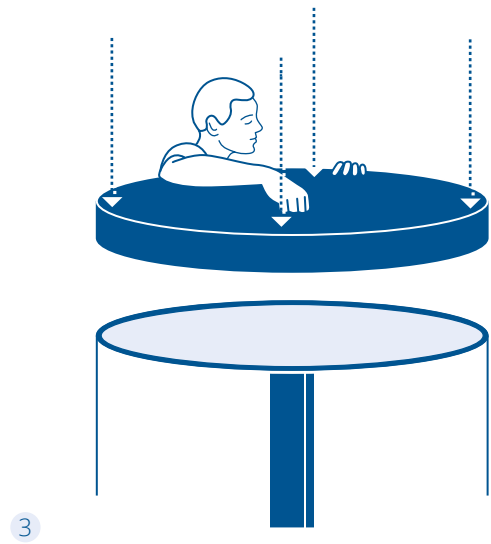
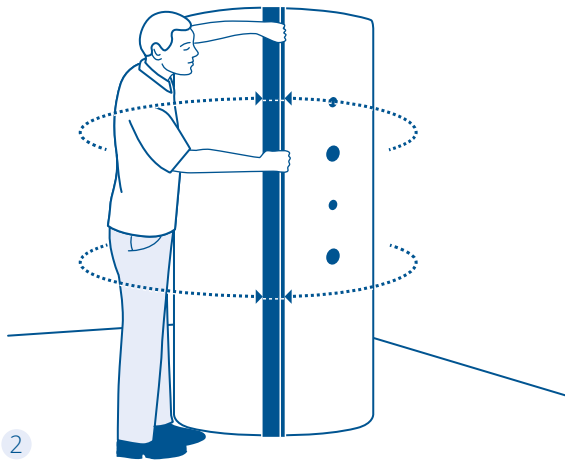
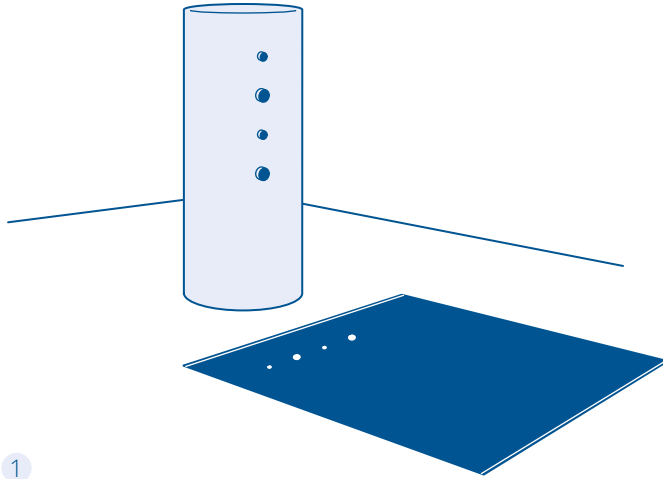



# Notes

A large grid of small dots for taking notes, consisting of 20 columns and 30 rows.





greiner  
PURTEC